



Books and Booklets INTRODUCTION

We are particularly well equipped to produce Books and Booklets and this is reflected in the exceptionally competitive prices we charge.

The easy to use tables on pages 61 - 64 allow virtually any permutation of size, quantity, material and printing to be priced quickly.

Material Choices

The material you would like to use for the inside pages of your Book or Booklet determines which table you should look at. For 100gm Executive paper

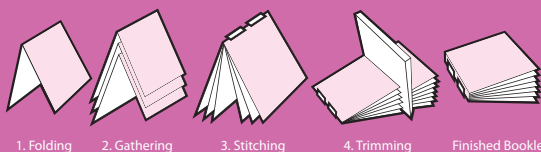

Please Note: Not all stitched Booklets are finished our way. Many are collated before folding and stitching. It's easier but results in a 'springy' Booklet.

or 100gm equest® paper inners please refer to page 62. For 115gm or 150gm Gloss or Silk Art please refer to page 63. For 160gm equest® or 200gm Gloss or Silk please refer to page 64.

In each case you can specify that your cover is to be printed on the same material as the inners, or choose covers printed on 200gm or 280gm Gloss or Silk (any of which can be laminated) or 300gm equest® Card (which is an uncoated material not suitable for lamination).

Binding Options: Wire Stitching (stapling)

This is ideal for Booklets with a smaller number of pages. We fold our sections prior to assembly resulting in Booklets which sit flat and look professional. For a small premium we can loop stitch Booklets. This gives the staples an eye so the booklet will fit in to a ring binder.

Perfect Binding (this catalogue is perfect bound)

For larger Books perfect binding is the most suitable option. Each of our price tables gives a recommended minimum number of pages required for perfect binding.

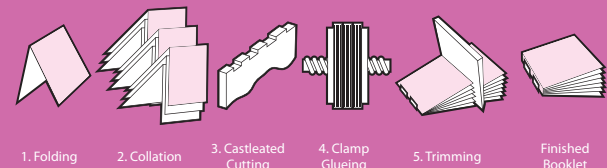

Orientation

All our prices are for Portrait (bound on the long edge) or Landscape (bound on the short edge) Books.

Non Standard Sizes

If you require a Non Standard size Booklet, e.g. a CD size (120mm square), simply price as the next standard size, in this case A5 (148mm x 210mm). We make no extra charge for trimming to a bespoke size.

Turnaround

The turnaround times shown are for up to 10,000 Wire Stitched Booklets and up to 1,250 Perfect Bound or Loop Stitched Booklets. For larger quantities please confirm turnaround at the time of ordering.

Book and Booklets Pricing System

Using our easy Booklet Pricing System virtually any Booklet permutation can be priced quickly and efficiently. The price is made up of a series of simple elements.

Step 1: Obtain the setup price for either Wire Stitched, Loop Stitched or Perfect Bound Booklets from **Table A** below.

Stitching Setup Cost		Table A	
Size	Wire Stitching Setup Cost	Loop Stitching Setup Cost	Perfect Binding Setup Cost
A6 148.5mm x 105mm	£153.00	£233.00	£351.50
1/3 A4 210mm x 99mm	£161.50	£241.50	£361.00
A5 210mm x 148.5mm	£182.75	£262.75	£370.50
A4 297mm x 210mm	£199.75	£279.75	£389.50
Square 210mm x 210mm	£199.75	£279.75	£389.50

Step 2: Obtain the price of your cover from **Table B**

Please Note: Miss out steps 2 and 3 if your Booklet cover is the same material as your inner pages and does not require lamination.

Size	Cost of 200gm Cover									Supplement for 280gm Cover				Supplement for 300gm equest [®] Cover				
	250				+per 100					250		+per 100		250		+per 100		
	Black & White	First Spot Colour	Per Extra Colour	Full Colour	Black & White	First Spot Colour	Per Extra Colour	Full Colour	250	+per 100	250	+per 100	250	+per 100				
A6 148.5mm x 105mm	£43.85	£58.68	£30.35	£186.86	0.01	£2.09	£1.91	£0.34	£3.83	0.04	£6.37	0.15	£0.89	0.06	£19.39	0.17	£2.71	0.06
1/3 A4 210mm x 99mm	£46.16	£61.76	£32.52	£196.69	0.15	£2.18	£2.02	£0.43	£4.68	0.06	£8.53	0.21	£1.19	0.08	£25.94	0.23	£3.63	0.09
A5 210mm x 148.5mm	£57.58	£74.40	£34.69	£245.93	0.22	£2.92	£2.73	£0.53	£5.41	0.09	£12.75	0.31	£1.78	0.13	£38.78	0.33	£5.43	0.14
A4 297mm x 210mm	£96.87	£112.55	£51.77	£321.08	0.44	£4.04	£3.91	£0.77	£7.57	0.18	£25.58	0.62	£3.58	0.25	£77.83	0.66	£10.90	0.27
Square 210mm x 210mm	£87.18	£101.29	£46.59	£288.97	0.29	£3.61	£3.49	£0.70	£6.97	0.12	£18.09	0.41	£2.53	0.17	£55.03	0.44	£7.70	0.18

Step 3: Obtain the price of your cover lamination from **Table C**

Please Note: Lamination is not possible on equest[®] 300gm Card. Only 200gm and 280gm Covers at Step 2 can be laminated.

Size	Cover Lamination			
	250		+per 100	
	Gloss	Matt	Gloss	Matt
A6 148.5mm x 105mm	£33.25	£36.94	£3.78	£4.33
1/3 A4 210mm x 99mm	£34.99	£38.88	£4.01	£4.56
A5 210mm x 148.5mm	£43.74	£48.60	£5.25	£5.85
A4 297mm x 210mm	£47.27	£52.49	£5.58	£7.70
Square 210mm x 210mm	£45.50	£50.54	£5.45	£6.82

Step 4: Obtain the price of your inner pages from **Table D** for your chosen material. See page 62 for 100gm Executive and equest[®] paper. See page 63 for 115gm and 150gm Gloss and Silk Art. Or see page 64 for 160gm equest[®] paper and 200gm Gloss and Silk Art.

Please Note: If the cover of your Booklet is the same material as the inner pages and not laminated, then include the cover (4 pages) in the page count when using **Table D**

Your Booklet is the sum of the amounts in Tables A, B, C and D

Step 5: Obtain the price for carriage by simply adding together the codes for the elements of your Booklet and then by referring to page 107.

All prices are + Carriage and VAT at applicable rates. Terms are payment with order.

Books & Booklets Inner pages printed on 100gm Executive or equest[®] paper

Please Note: The tables on this page must be read in conjunction with those on pages 61 to price all elements of your Booklet. Also, a sheet of paper is 2 pages and the number of pages in a Book must always be a multiple of 4 pages.

Table D Additional cost per page on 100gm Executive

Size	250				+per 100			
	Black & White	First Spot Colour	Per Extra Colour	Full Colour	Black & White	First Spot Colour	Per Extra Colour	Full Colour
A6 148.5mm x 105mm	£4.80	£8.94	£7.69	£23.50	£0.41	£0.37	£0.09	£0.34
1/3 A4 210mm x 99mm	£4.86	£9.70	£8.36	£27.88	£0.43	£0.39	£0.11	£0.45
A5 210mm x 148.5mm	£6.39	£10.49	£8.83	£30.63	£0.52	£0.49	£0.14	£0.55
A4 297mm x 210mm	£11.28	£16.20	£12.79	£47.59	£0.84	£0.79	£0.19	£0.86
Square 210mm x 210mm	£10.60	£15.10	£11.56	£42.64	£0.75	£0.71	£0.17	£0.78
Extra per page for Perfect Binding	£0.73				£0.07			

Turnaround Options ▶

6 Express Working Days*
3 Express Plus Working Days*
12 Economy Working Days*

Table D Additional cost per page on 100gm equest[®]

Size	250				+per 100			
	Black & White	First Spot Colour	Per Extra Colour	Full Colour	Black & White	First Spot Colour	Per Extra Colour	Full Colour
A6 148.5mm x 105mm	£5.54	£9.68	£7.69	£24.24	£0.70	£0.67	£0.09	£0.64
1/3 A4 210mm x 99mm	£5.85	£10.70	£8.36	£28.88	£0.83	£0.78	£0.11	£0.85
A5 210mm x 148.5mm	£7.88	£11.97	£8.83	£32.11	£1.12	£1.08	£0.14	£1.14
A4 297mm x 210mm	£14.26	£19.18	£12.79	£50.57	£2.03	£1.98	£0.19	£2.05
Square 210mm x 210mm	£12.71	£17.21	£11.56	£44.75	£1.59	£1.55	£0.17	£1.63
Extra per page for Perfect Binding	£0.73				£0.07			

Turnaround Options ▶

8 Express Working Days*
4 Express Plus Working Days*
16 Economy Working Days*

100gm Executive Inner Pages

For 100gm Executive Wire Stitching or Loop Stitching is possible between 8 and 80 pages. Perfect Binding is possible from 56 pages.

100gm equest[®] Inner Pages

For 100gm equest[®] Wire Stitching or Loop Stitching is possible between 8 and 84 pages. Perfect Binding is possible from 60 pages.

*Up to 10,000 for Wire Stitched Booklets and up to 1,250 for Perfect Bound or Loop Stitched Booklets. For larger quantities turnaround agreed at time of order. All prices are + Carriage and VAT at applicable rates. Terms are payment with order.

Further Information

Turnaround

Times quoted are from receipt of full payment and complete, print ready, PDF artwork. Designs with heavy ink coverage may take longer to dry and we reserve the right to extend turnarounds in such cases.

Artwork

Important artwork preparation information can be found on pages 101 - 105.

Special Print Option

Hexachrome and Metal FX printing is available at a premium over Full Colour Printing with additional turnaround. Please see page 105 for details and examples.



Books & Booklets Inner pages printed on 115gm or 150gm Gloss or Silk Art

Please Note: The tables on this page must be read in conjunction with those on pages 61 to price all elements of your Booklet. Also, a sheet of paper is 2 pages and the number of pages in a Book must always be a multiple of 4 pages.

115gm Gloss or Silk Art Inner Pages

For 115gm Gloss or Silk Art Wire Stitching or Loop Stitching is possible between 8 and 80 pages. Perfect Binding is possible from 56 pages.

Additional cost per page on 115gm Gloss or Silk Art Table D										
Size	250				+per 100					
	Black & White	First Spot Colour	Per Extra Colour	Full Colour	Black & White	First Spot Colour	Per Extra Colour	Full Colour		
A6 148.5mm x 105mm	£4.80	£8.94	£7.69	£23.50	0.05	£0.41	£0.37	£0.09	£0.34	0.02
1/3 A4 210mm x 99mm	£4.86	£9.70	£8.36	£27.88	0.06	£0.43	£0.39	£0.11	£0.45	0.02
A5 210mm x 148.5mm	£6.39	£10.49	£8.83	£30.63	0.09	£0.52	£0.49	£0.14	£0.55	0.04
A4 297mm x 210mm	£11.28	£16.20	£12.79	£47.59	0.18	£0.84	£0.79	£0.19	£0.86	0.07
Square 210mm x 210mm	£10.60	£15.10	£11.56	£42.64	0.12	£0.75	£0.71	£0.17	£0.78	0.05
Extra per page for Perfect Binding	£0.73				£0.07					

Turnaround Options ▶

6 Express Working Days*
3 Express Plus Working Days*
12 Economy Working Days*

150gm Gloss or Silk Art Inner Pages

For 150gm Gloss or Silk Art Wire Stitching or Loop Stitching is possible between 8 and 60 pages. Perfect Binding is possible from 44 pages.

Additional cost per page on 150gm Gloss or Silk Art Table D										
Size	250				+per 100					
	Black & White	First Spot Colour	Per Extra Colour	Full Colour	Black & White	First Spot Colour	Per Extra Colour	Full Colour		
A6 148.5mm x 105mm	£5.54	£9.68	£7.69	£24.24	0.60	£0.70	£0.67	£0.09	£0.64	0.02
1/3 A4 210mm x 99mm	£5.85	£10.70	£8.36	£28.88	0.76	£0.83	£0.78	£0.11	£0.85	0.03
A5 210mm x 148.5mm	£7.88	£11.97	£8.83	£32.11	0.11	£1.12	£1.08	£0.14	£1.14	0.05
A4 297mm x 210mm	£14.26	£19.18	£12.79	£50.57	0.23	£2.03	£1.98	£0.19	£2.05	0.09
Square 210mm x 210mm	£12.71	£17.21	£11.56	£44.75	0.16	£1.59	£1.55	£0.17	£1.63	0.06
Extra per page for Perfect Binding	£0.73				£0.07					

Turnaround Options ▶

6 Express Working Days*
3 Express Plus Working Days*
12 Economy Working Days*

*Up to 10,000 for Wire Stitched Booklets and up to 1,250 for Perfect Bound or Loop Stitched Booklets.

For larger quantities turnaround agreed at time of order.

All prices are + Carriage and VAT at applicable rates. Terms are payment with order.

Bespoke Sizes

If the particular size you require is not listed then we can produce Bespoke Sizes. Simply price the next size up. For example, a 279mm x 198mm video sleeve will be priced as an A4 (297mm x 210mm). Please specify your required size at the time of order and we will trim free of charge.

Carriage (Applicable on delivered items only)

Please calculate the carriage costs by adding together the green carriage codes for each product ordered. When you have the sum total please refer to the carriage table on page 106 to obtain the carriage cost. Full carriage details can be found on page 107. Alternatively please confirm the cost at the time of ordering.

This page is printed on 115gm Triple Coated Silk Art Paper



Books & Booklets Inner pages printed on 160gm equest[®] or 200gm Gloss or Silk Art

Please Note: The tables on this page must be read in conjunction with those on pages 61 to price all elements of your Booklet. Also, a sheet of paper is 2 pages and the number of pages in a Book must always be a multiple of 4 pages.

Table D Additional cost per page on 160gm equest[®]

Size	250				+per 100			
	Black & White	First Spot Colour	Per Extra Colour	Full Colour	Black & White	First Spot Colour	Per Extra Colour	Full Colour
A6 148.5mm x 105mm	£12.80	£16.77	£7.69	£32.58	£0.94	£0.89	£0.09	£0.85
1/3 A4 210mm x 99mm	£15.62	£20.02	£8.36	£38.38	£1.12	£1.07	£0.11	£1.11
A5 210mm x 148.5mm	£21.95	£26.24	£8.83	£45.98	£1.55	£1.50	£0.14	£1.55
A4 297mm x 210mm	£42.41	£47.26	£12.79	£78.49	£2.86	£2.82	£0.19	£2.85
Square 210mm x 210mm	£32.57	£37.07	£11.56	£64.97	£2.22	£2.17	£0.17	£2.20
Extra per page for Perfect Binding	£0.73				£0.07			

Turnaround Options ▶

8 Express Working Days*
4 Express Plus Working Days*
16 Economy Working Days*

160gm equest[®] Inner Pages

For 160gm equest[®] Wire Stitching or Loop Stitching is possible between 8 and 52 pages. Perfect Binding is possible from 40 pages.

Table D Additional cost per page on 200gm or Silk Art

Size	250				+per 100			
	Black & White	First Spot Colour	Per Extra Colour	Full Colour	Black & White	First Spot Colour	Per Extra Colour	Full Colour
A6 148.5mm x 105mm	£5.43	£9.72	£7.69	£26.42	£0.59	£0.54	£0.09	£0.49
1/3 A4 210mm x 99mm	£5.76	£10.15	£8.36	£32.61	£0.61	£0.57	£0.11	£0.62
A5 210mm x 148.5mm	£7.20	£11.59	£8.83	£34.81	£0.76	£0.71	£0.14	£0.78
A4 297mm x 210mm	£12.67	£18.90	£12.79	£55.83	£1.25	£1.19	£0.19	£1.27
Square 210mm x 210mm	£11.59	£16.99	£11.56	£49.93	£1.13	£1.07	£0.17	£1.14
Extra per page for Perfect Binding	£0.73				£0.07			

Turnaround Options ▶

6 Express Working Days*
3 Express Plus Working Days*
12 Economy Working Days*

200gm Gloss or Silk Art Inner Pages

For 200gm Gloss or Silk Art Wire Stitching or Loop Stitching is possible between 8 and 48 pages. Perfect Binding is possible from 36 pages.

*Up to 10,000 for Wire Stitched Booklets and up to 1,250 for Perfect Bound or Loop Stitched Booklets. For larger quantities turnaround agreed at time of order. All prices are + Carriage and VAT at applicable rates. Terms are payment with order.

Further Information

Turnaround

Times quoted are from receipt of full payment and complete, print ready, PDF artwork. Designs with heavy ink coverage may take longer to dry and we reserve the right to extend turnarounds in such cases.

Artwork

Important artwork preparation information can be found on pages 101 - 105.

Special Print Option

Hexachrome and Metal FX printing is available at a premium over Full Colour Printing with additional turnaround. Please see page 105 for details and examples.

Bespoke Sizes

If the particular size you require is not listed then we can produce Bespoke Sizes. Simply price the next size up. For example, a 279mm x 198mm video sleeve will be priced as an A4 (297mm x 210mm). Please specify your required size at the time of order and we will trim free of charge.

Carriage (Applicable on delivered items only)

Please calculate the carriage costs by adding together the green carriage codes for each product ordered. When you have the sum total please refer to the carriage table on page 106 to obtain the carriage cost. Full carriage details can be found on page 107. Alternatively please confirm the cost at the time of ordering.